

A-A (1:1.5)

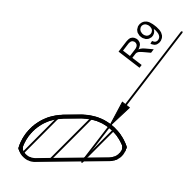

B-B (1:1.5)

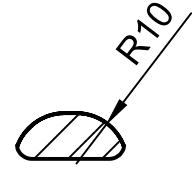

C-C (1:1.5)

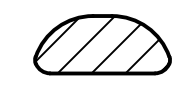

D-D (1:1.5)

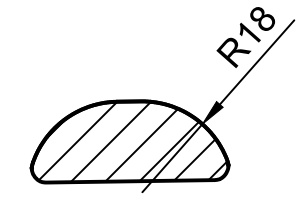

E-E (1:1.5)

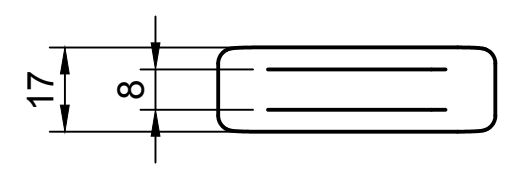

**nano**

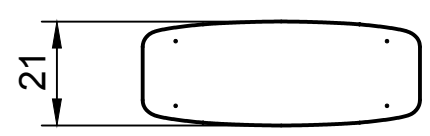

**2t**



**5t**

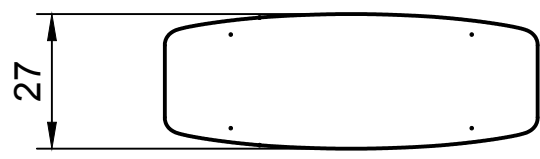

**10t**

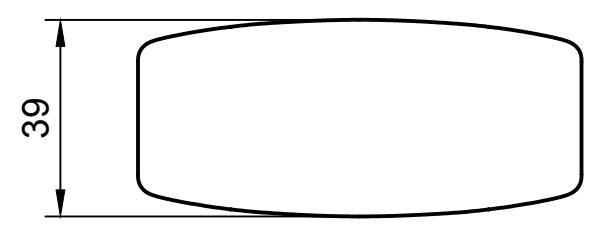

**20t**

<b>Model</b>	nano	2t	5t	10t	20t
<b>Max Working Load</b>	600kg	2t	5t	10t	20t
<b>Strop Diameter</b>	4mm	9mm	10.7mm	12.4mm	15mm
<b>Mass</b>	72g	160g	210g	360g	798g

<p>Cyclops Marine A2 G005 Cody Technology Park Old Ivelly Road Farnborough GU14 0LX</p>	Project <b>smartlink</b>		Drawn Will Birch Tomlinson	Date 17/08/2020
	Title <b>Sensor Range</b>		Approved Sam Cray	Date 19/08/2020
	Part		Rev. <b>B</b>	Issue
	Finish <b>Machined</b>		Material <b>Acetal/Al6082-T6/Ti6Al4v</b>	
	Scale 4:5	Format A3	Sheet 1/1	Dimensions: mm, degrees Tolerance unless stated: 0.1mm, 0.1° <small>© Cyclops Marine Limited. All rights reserved. Reproduction, use and dissemination of this drawing may only be undertaken with the prior consent of Cyclops Marine Limited. Do not scale.</small>