

BOW BRACKET 508-783-01, -02 AND -04

The bow bracket is an assembly of:

508-783	Bow bracket plate
508-784	Bow bracket ring
158-007	Nylock Nut M10
162-091	Screw M10
153-128	Grub screw M5
534-xxx*	Bushing bow bracket
592-022	Allen key

* See table

Part No.	Aluminum section	Carbon section
534-905	Ø 72	-
534-906	Ø 75	Ø 76
534-882	Ø 84	Ø 88 and Ø 89

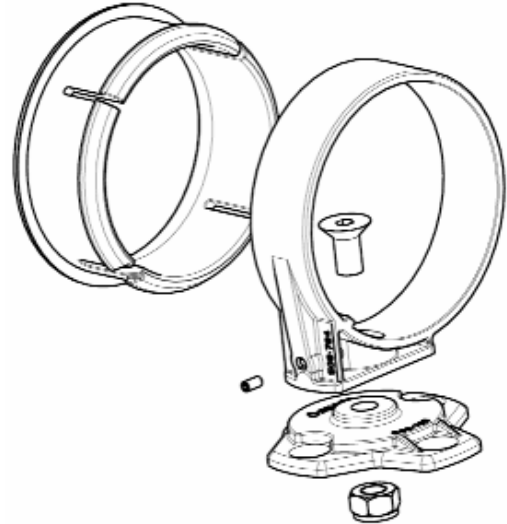

Placement

The bow bracket is to be placed with the continuous edge of the bushing facing forward.

The bow bracket plate must be fixed to the deck with **3x M8** machine screws. An under deck support plate is recommended.

The bow bracket plate can be fixed in any direction, but preferably with the single screw aft.

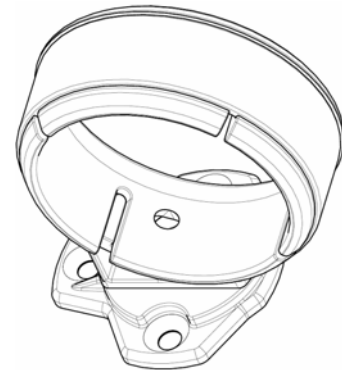

Function

The bow ring is designed either to fit tightly on the bow bracket plate or to swivel around the M10 screw (when extending/retracting the bowsprit, not when sailing).

If the ring is to swivel, the M5 grub screw must be fitted. The grub screw will prevent the M10 screw from unscrewing itself when the bow ring rotates.

