

KIT STANDARD

- Comprends également :
 - x1 Housse de protection / x1 Protection cover (29050000345)
 - x1 Sac de rangement / x1 Storage bag (29050000343)

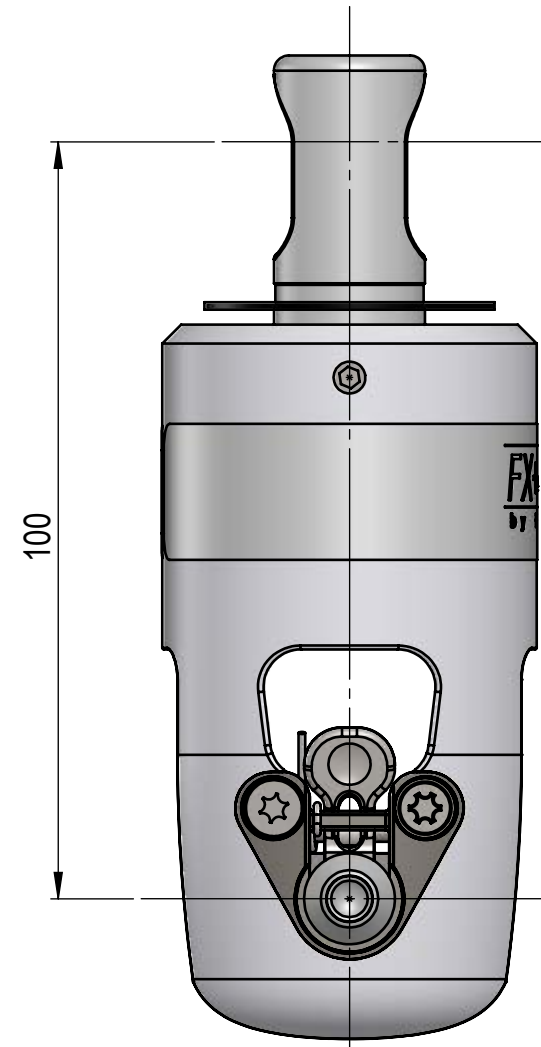

Émerillon FX+ 4500 /
FX+ 4500 Swivel
43420104530
Poids / Weight : 493g

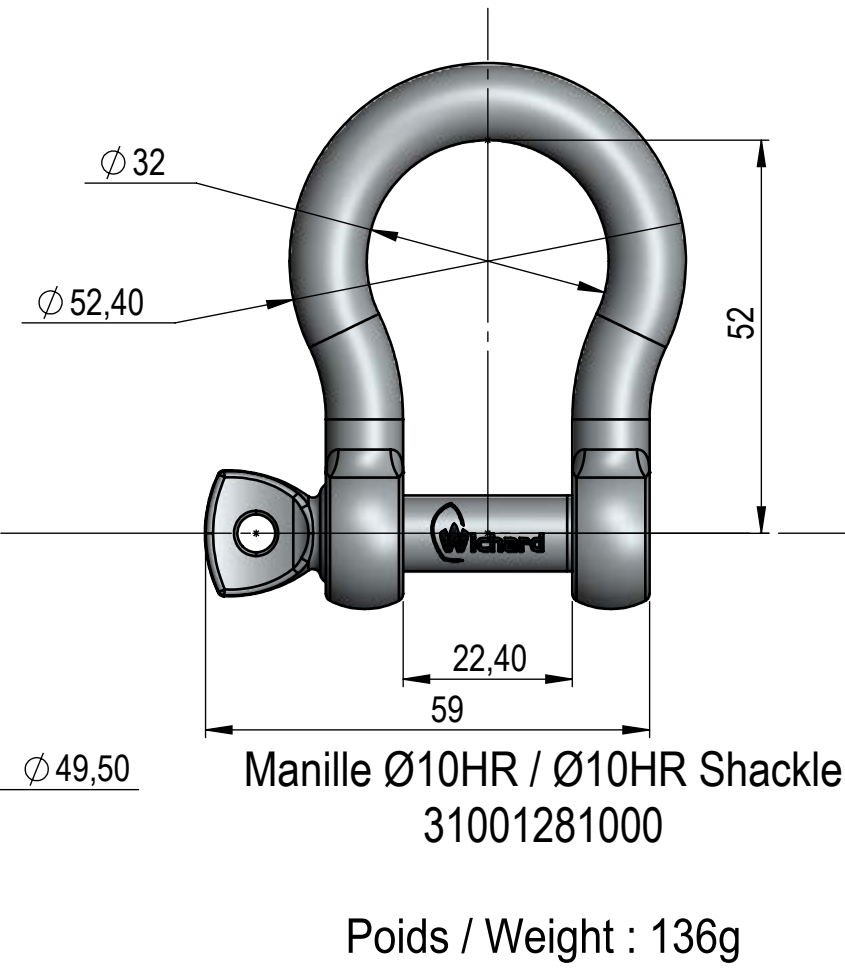
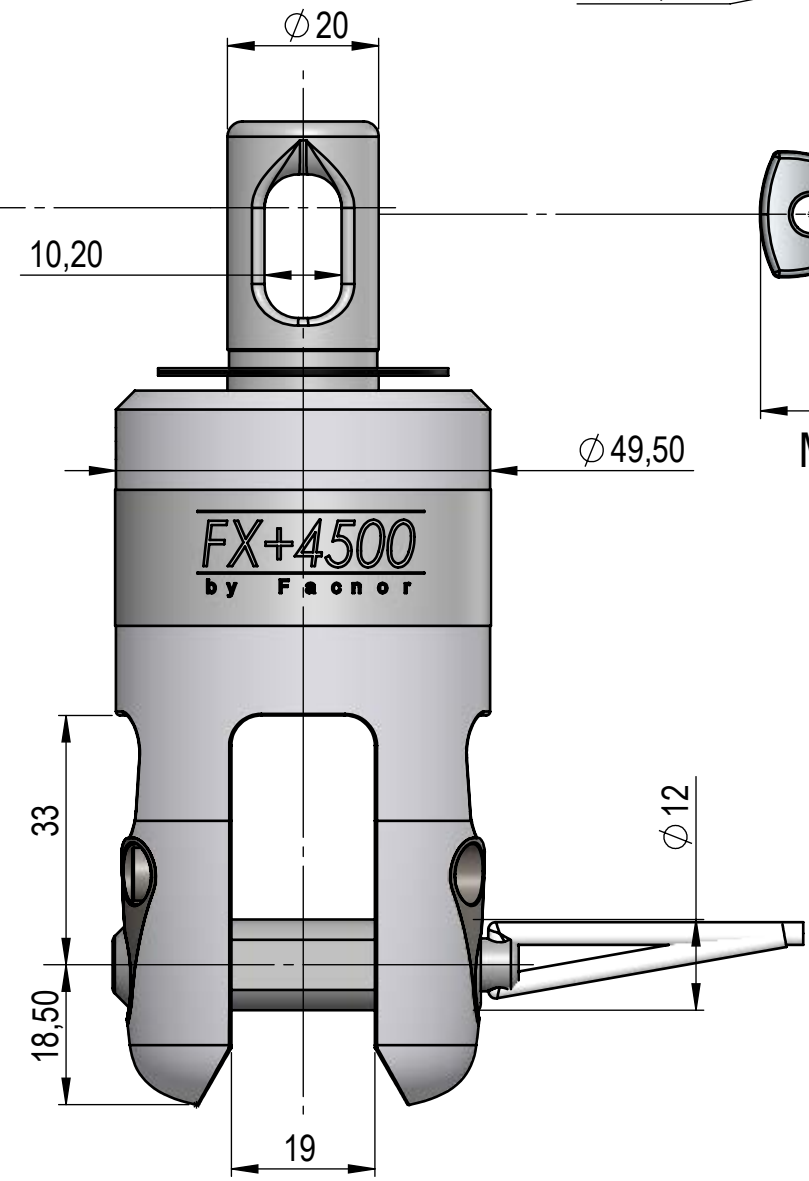

OPTIONS

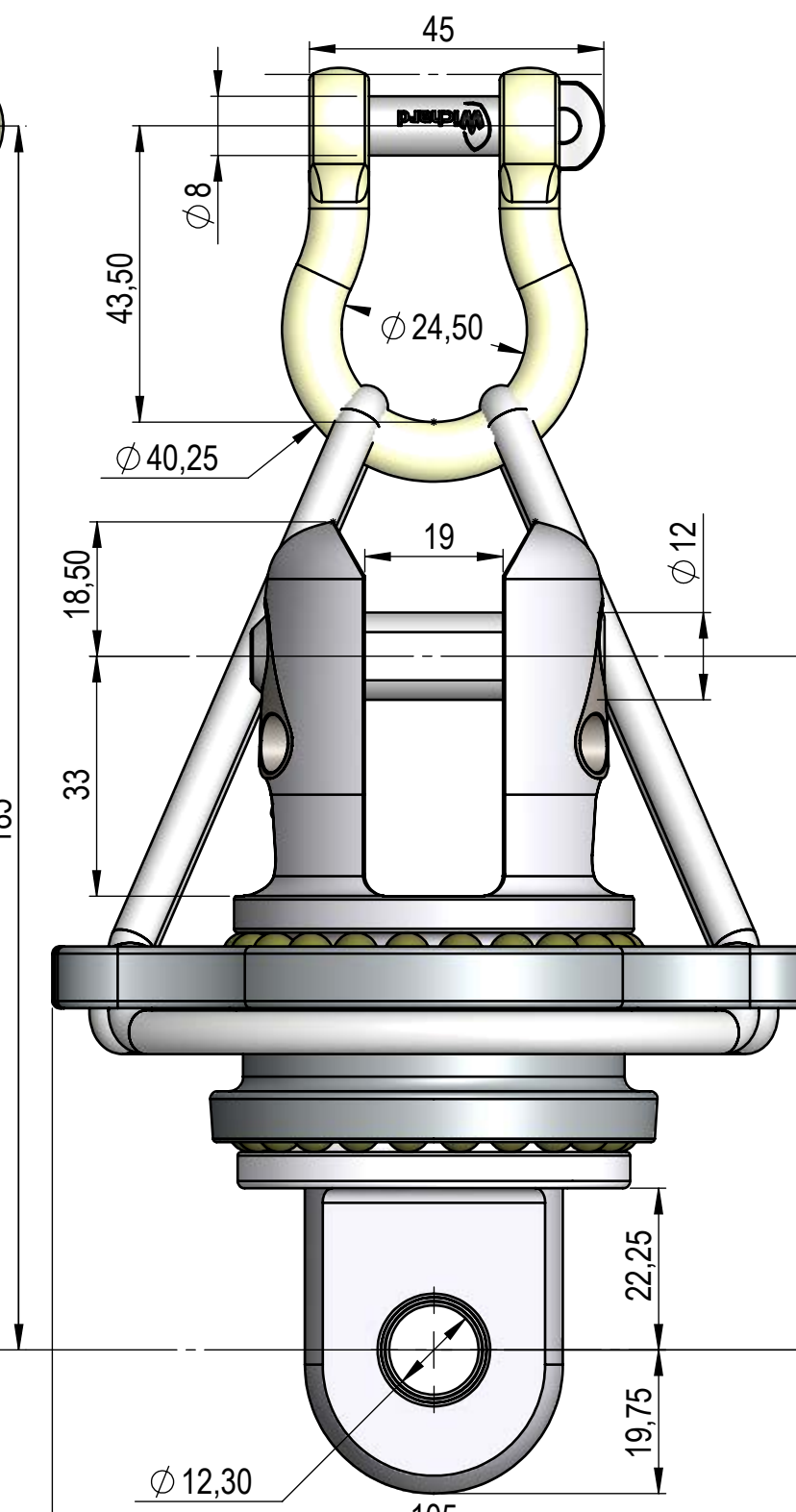
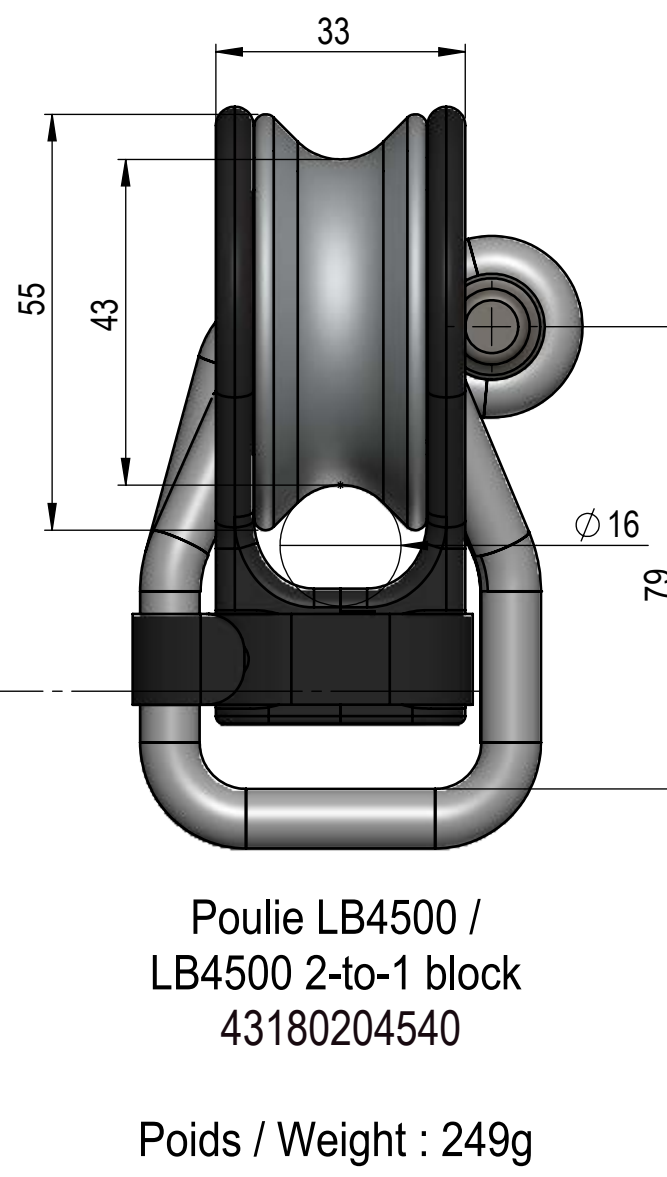
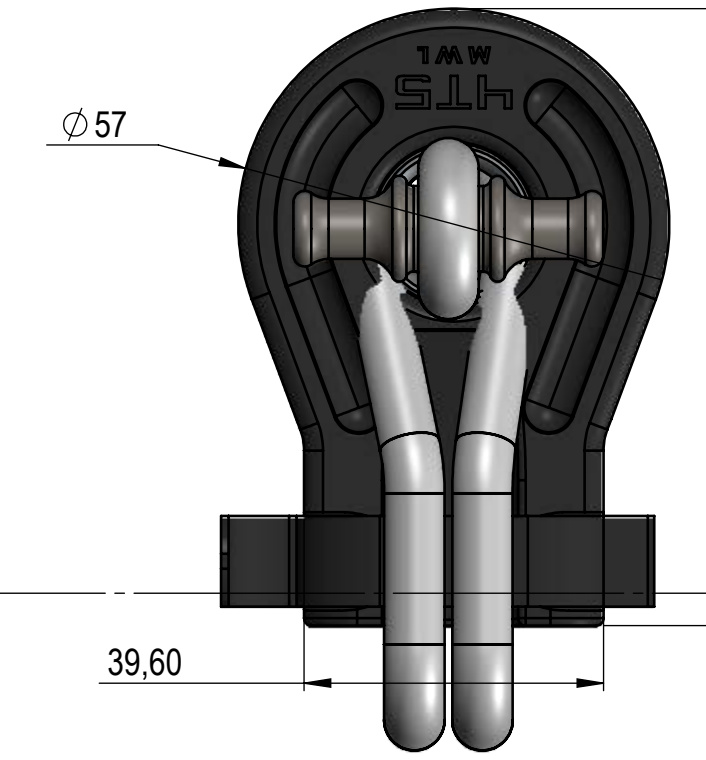

Cosse FAST 4500 / FAST 4500 Thimble
43230004540
(Fournie avec Loop / Supplied with Loop)
Poids / Weight : 584g

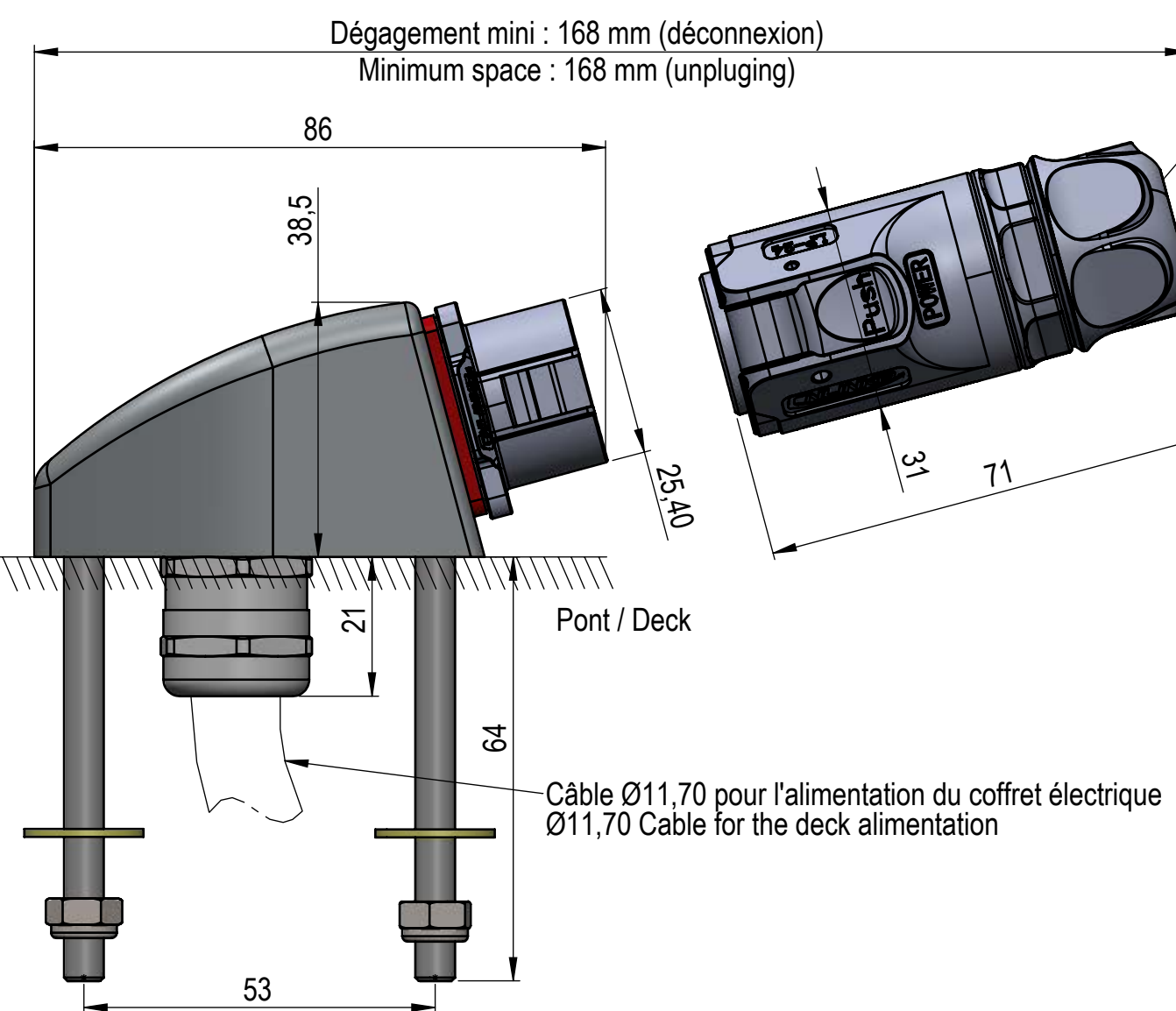
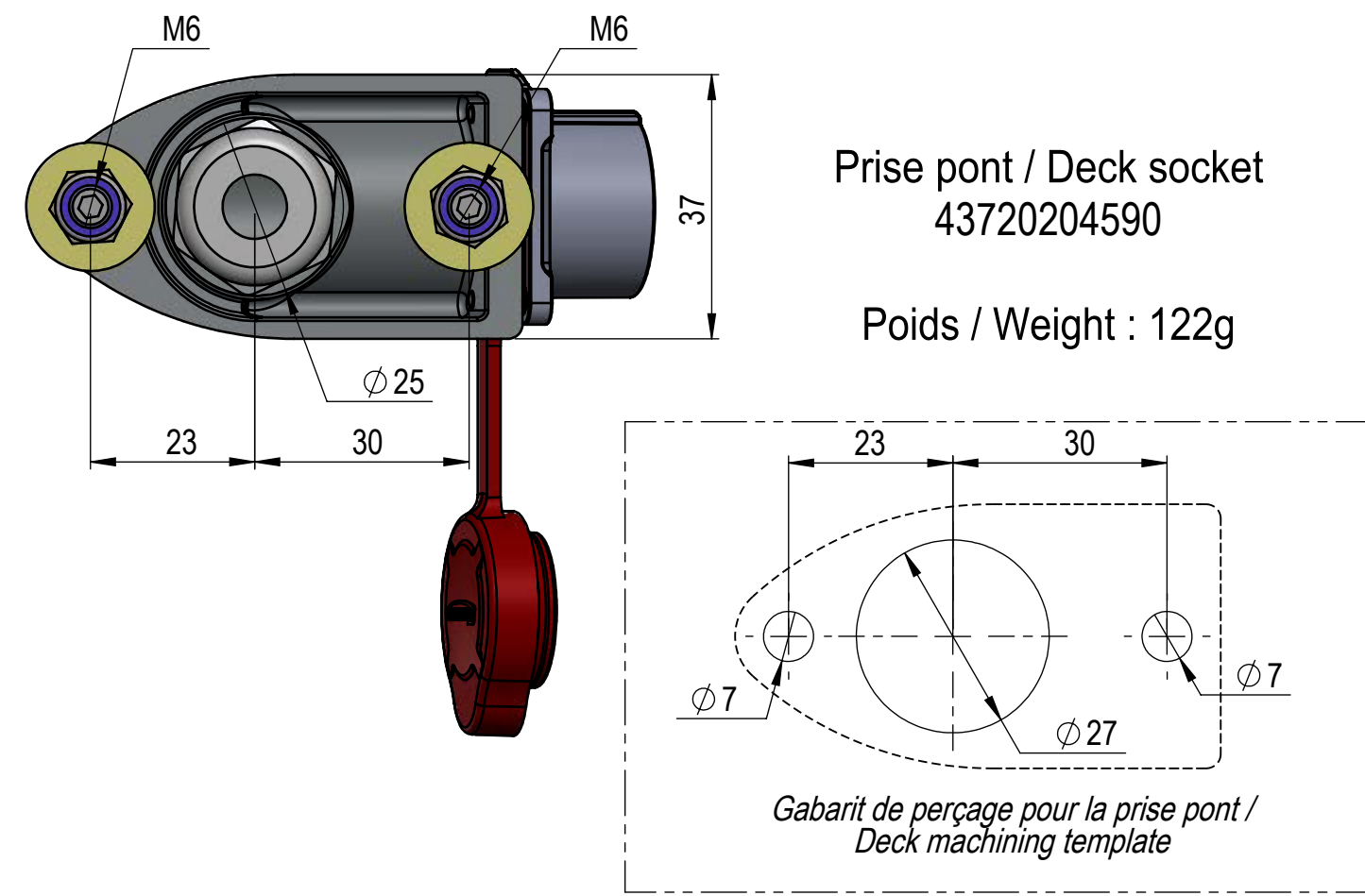
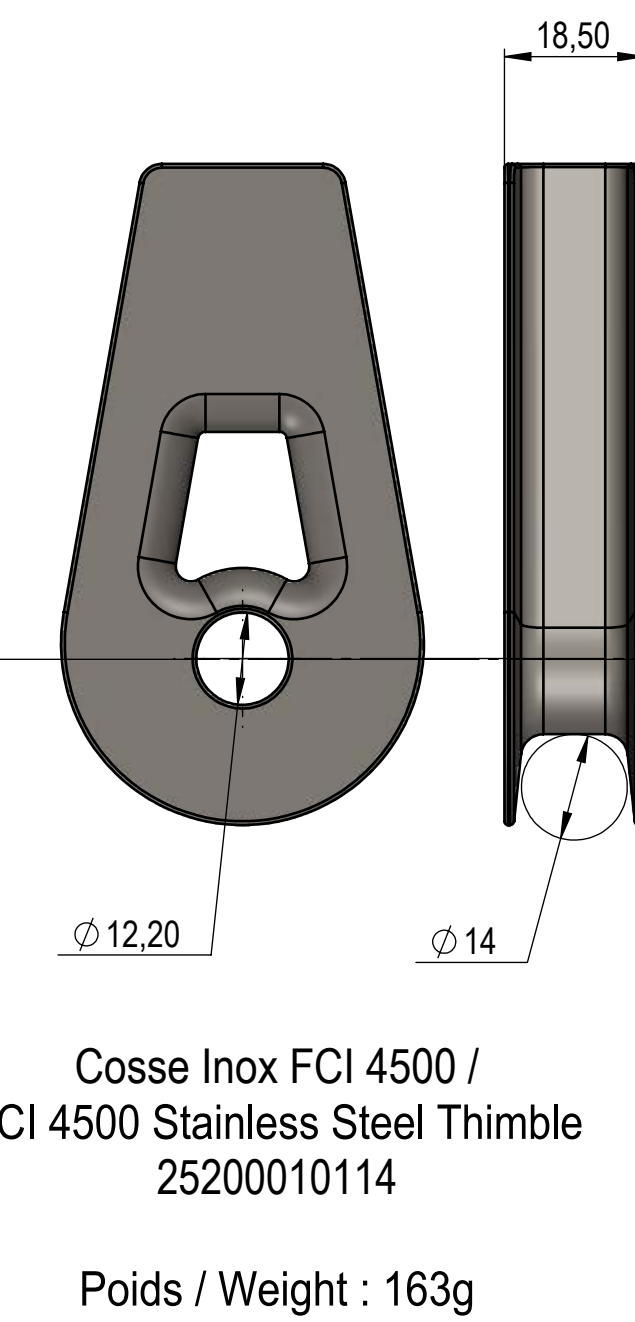

Câble électrique Ø11,70 Long. max 6m (se référer à la notice)
Ø11,70 Electric cable Lgth. max 6m (look the instruction)

INFORMATION	
PUISSANCE / POWER	400 W
ALIMENTATION / POWER SUPPLY	12 V
CHARGE DE TRAVAIL MAXI. / MAX. WORKING LOAD	4.5 T
VITESSE D'ENROULEMENT / FURLING SPEED	85 RPM

Bloc moteur FXE 4500 électrique /
Electric drive unit FXE 4500
43720204530

Poids / Weight : 4780g

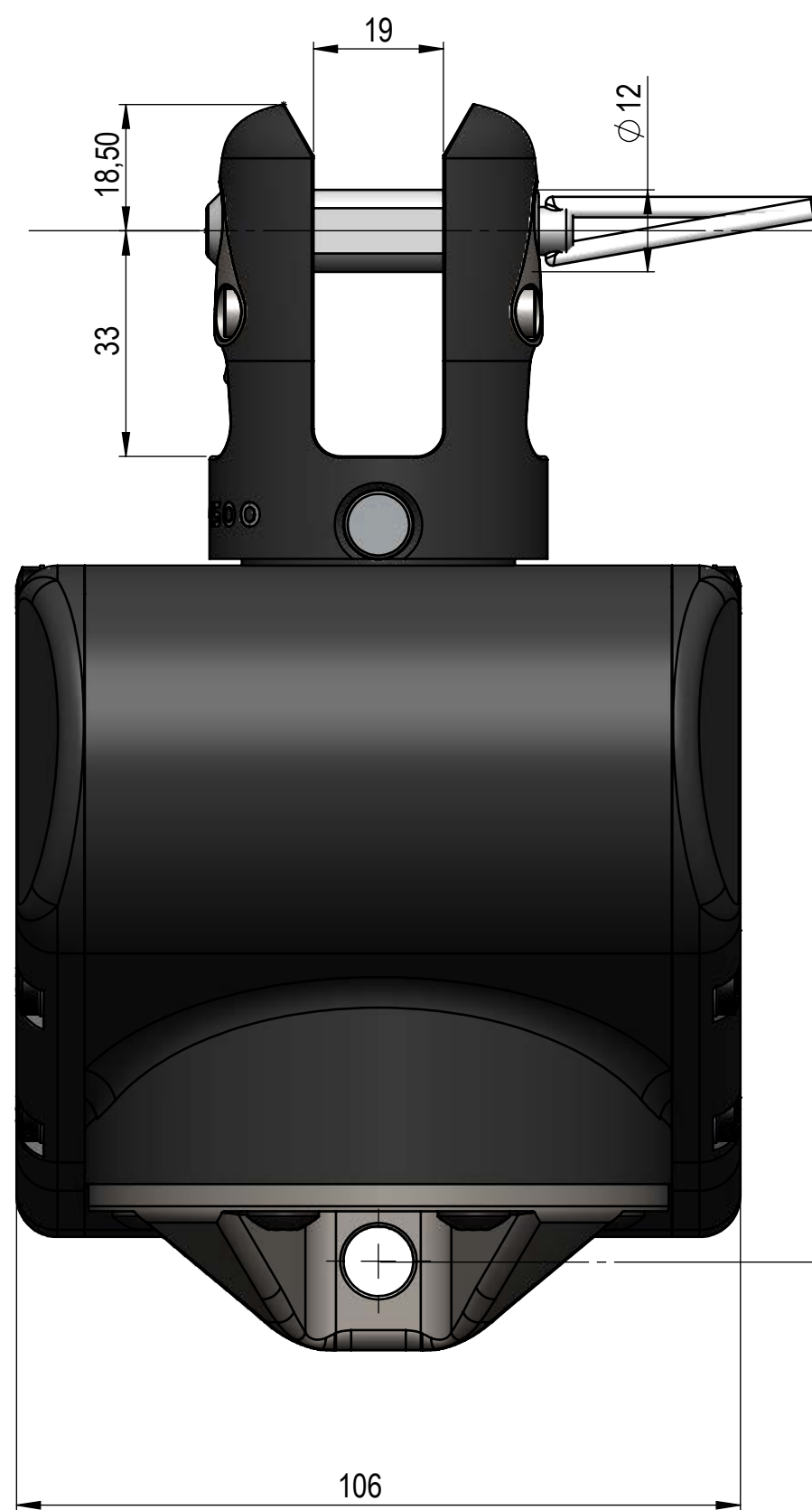

Mousqueton Ø10 /
Ø10 Snapshackle
31003271800

Poids / Weight : 257g

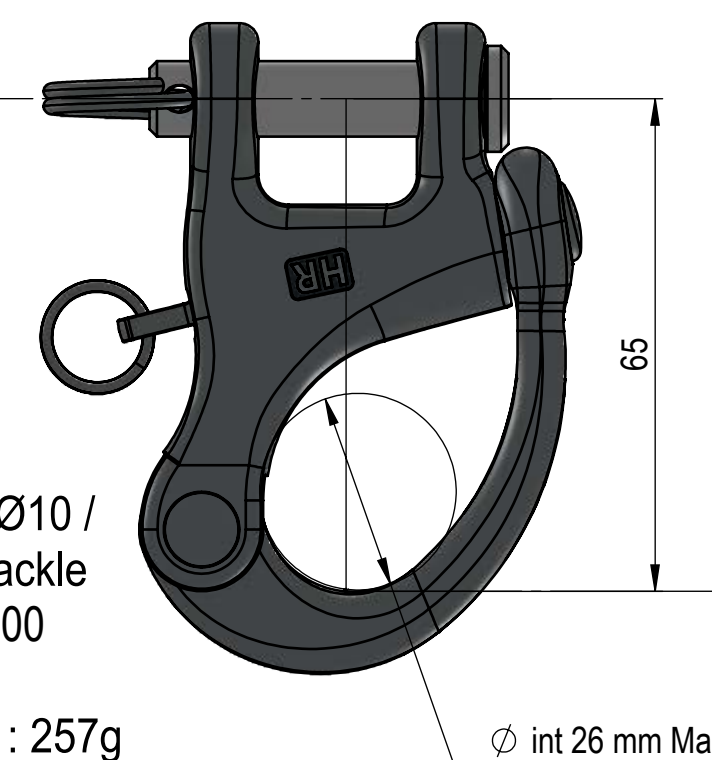

Adaptateur friction /
Soft converter SFT4500
25200180010
Poids / Weight : 61g

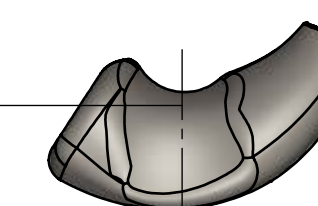

ECHELLE 1:1 / Full Scale

REV.	DATE	AUTEUR	APPROUVE	DESCRIPTION
				Emmagasineur FXE 4500 - Encombrement Code Sail Furler FXE 4500 - Dimensions
Ech: 1:1 A1				Indice:
Matière: x		Etat Final: x		Usiné: X
Auteur: LGosselin		Date: 05/07/2022		Usiné: X
Toi.Gén.: ISO 2768-mK		Ra.Gén.: √ ^{RG} T ₂ ✓		Usiné: X
				Etude: 05072022L001