

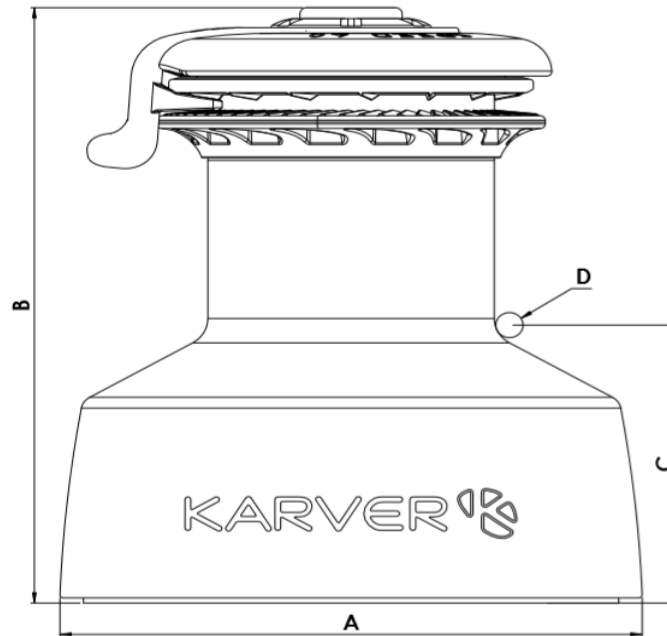

WINCHES SPECIFICATIONS*

MODELS	Speed Vitesses	MWL / Charge		Max Speed		Max power		Base/Embase (A)		Height/Hauteur (B)		Line Entry/Entrée (C)		Line ϕ / Cordage (D)	
		Kg	lbs	cm/tour	inch/turn	Kg	lbs	ϕ mm	ϕ inches	mm	inches	mm	inches	mm	inches
KWK45 - Kompact	2	850	1 870	26,4	10,40	45	99	130	5,12	143	5,63	58	2,28	8 > 12	5/16 > 1/2
KWS40 - Extra speed	4	850	1 870	69,4	27,32	40	88	171	6.73	189	7.44	87	3.43	8 > 12	5/16 > 1/2
KWS46 - Extra speed	4	1 300	2 860	68,3	26,89	46,6	103	206	8.11	203	7.99	97	3.82	8 > 14	5/16 > 9/16
KWS52 - Extra speed	4	1 500	3 300	65,4	25,74	55,4	122	220	8.66	203	7.99	97	3.82	8 > 14	5/16 > 9/16
KWP110 - Extra Power	4	1 000	2 200	13,7	5,39	113	249	171	6.73	189	7.44	87	3.43	8 > 12	5/16 > 1/2
KWP130 - Extra Power	4	1 500	3 300	13,6	5,35	131	289	206	8.11	203	7.99	97	3.82	8 > 14	5/16 > 9/16
KWP150 - Extra Power	4	1 800	3 970	13,1	5,16	156	344	220	8.66	203	7.99	97	3.82	8 > 14	5/16 > 9/16

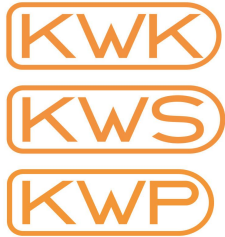

* Non contractual datas. Subject to modifications

* Données non contractuelles. Sous réserve de modifications